

Where the release mechanism of the self-latching device is located less than 54 inches (1372 mm) from the bottom of the gate, the release mechanism and openings shall comply with the following:

- The release mechanism shall be located on the pool side of the gate at least 3 inches (76 mm) below the top of the gate; and
- The gate and barrier shall have no opening larger than 1/2 inch (13 mm) within 18 inches (457 mm) of the release mechanism.

9. Where a wall of a dwelling serves as part of the barrier, one of the following conditions shall be met:

- The pool shall be equipped with a powered safety cover in compliance with ASTM F 1346; or
- Doors with direct access to the pool through that wall shall be equipped with an alarm which produces an audible warning when the door and/or its screen, if present, are opened. The alarm shall be listed in accordance with UL 2017. The audible alarm shall activate within 7 seconds and sound continuously for a minimum of 30 seconds after the door and/or its screen, if present, are opened and be capable of being heard throughout the house during normal household activities. The alarm shall automatically reset under all conditions. The alarm system shall be equipped with a manual means, such as touch pad or switch, to temporarily deactivate the alarm for a single opening. Deactivation shall last for not more than 15 seconds. The deactivation switch(es) shall be located at least 54 inches (1372 mm) above the threshold of the door; or
- Other means of protection, such as self-closing doors with self-latching devices, which are approved by the governing body, shall be acceptable so long as the degree of protection afforded is not less than the protection afforded by Item 9 described above.

10. Where an above-ground pool structure is used as a barrier or where the barrier is mounted on top of the pool structure, and the means of access is a ladder or steps:

- The ladder or steps shall be capable of being secured, locked or removed to prevent access; or
- The ladder or steps shall be surrounded by a barrier that meets the requirements of Items 1 through 9. When the ladder or steps are secured, locked or removed, any opening created shall not allow the passage of a 4-inch-diameter (102 mm) sphere.

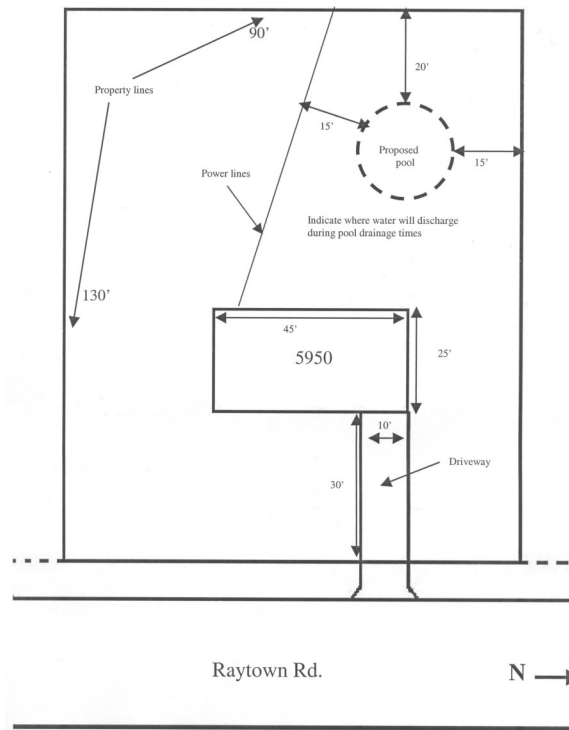

A site plan is a "birds eye" view of the entire property. This plan is required when constructing a new building, adding to a driveway, adding roof area to an existing building, or enclosing any space under an existing roof. The site plan must show the location and dimension of the property lines, easements, adjacent streets, and all proposed construction. In addition, the site plan must indicate the distances between buildings on the property and the distance from each building to each property line. The square footage of all new and existing buildings, driveways, garages, and carports should also be shown.



Community Development Department
 10000 E. 59 St.
 Raytown MO 64133
 Phone: (816) 737-6011
 Fax: (816) 737-6164



Swimming pool Information

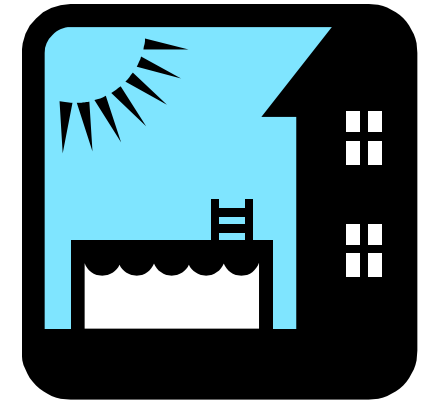

Community Development
 Department
 10000 E. 59 St.
 Raytown MO 64133
 (816) 737-6011

Pool requirements

Any pool, spa, or hot tub capable of holding 24 inches of water must have a construction permit obtained and the construction approved prior to using the pool.

PERMIT REQUIREMENTS

1. Submit the following items:
 - Permit application
 - 2 copies of site plan (see sample)

ZONING CODE REGULATIONS

1. Private swimming pools located behind the front edge of the structure, if more than two (2) feet deep, are subject to the following conditions and requirements:
 - They must be located behind the front building line and not less than ten (10) feet from any rear or side lot line, and in the case of corner lots, not less than fifteen (15) feet from a side street line and at least twenty (20) feet from a principal building on an adjoining lot.
 - If located in the side yard, they shall not be less than forty (40) feet from the front line and not less than fifteen (15) feet from the side lot line.
 - The area in which the pool is located shall be entirely enclosed and separated from adjoining property by a protective fence or other permanent structure of a non-climbable variety at least four (4) feet in height but less than six (6) feet in height.
 - Such protective enclosures shall be provided with gates equipped with locks, which shall be locked when the pool is not attended.
 - Adequate pool-drainage facilities shall be provided for which the plans and specifications shall be approved by the Director of Community Development or some other duly qualified individual.

ELECTRICAL REQUIREMENTS

1. Power lines (overhead or buried) must have a 10 foot horizontal clearance measured from the inside wall of the pool.
2. A 125-volt convenience receptacle shall be located a minimum of 10 feet from and not more than 20 feet from the inside wall of the pool.
Exception: A receptacle that provides power for a water-pump motor shall be permitted to be between 5 and 10 feet from the wall or edge of the pool.
3. All receptacles located within 20 feet of the wall of the pool shall be protected by a ground fault circuit interrupter.
4. In-ground pools and items such as underwater lighting must have an electrical bonding inspection.
5. Extension cords may not be substituted for permanent wiring.

BARRIER REQUIREMENTS

These provisions shall control the design of barriers for residential swimming pools, spas and hot tubs. These design controls are intended to provide protection against potential drowning and near drownings by restricting access to swimming pools, spas and hot tubs.

An outdoor swimming pool, including an in-ground, above-ground or on-ground pool, hot tub or spa shall be surrounded by a barrier which shall comply with the following:

1. The top of the barrier shall be at least 48 inches (1219 mm) above grade measured on the side of the barrier which faces away from the swimming pool. The maximum vertical clearance between grade and the bottom of the barrier shall be 2 inches (51 mm) measured on the side of the barrier which faces away from the swimming pool. Where the top of the pool structure is above grade, such as an above-ground pool, the barrier may be at ground level, such as the pool structure, or mounted on top of the pool structure. Where the barrier is mounted on top of the pool structure, the maximum vertical clearance between the top of the pool structure and the bottom of the barrier shall be 4 inches (102 mm).
2. Openings in the barrier shall not allow passage of a 4-inch-diameter (102 mm) sphere.

3. Solid barriers, which do not have openings, such as a masonry or stone wall, shall not contain indentations or protrusions except for normal construction tolerances and tooled masonry joints.
4. Where the barrier is composed of horizontal and vertical members and the distance between the tops of the horizontal members is less than 45 inches (1143 mm), the horizontal members shall be located on the swimming pool side of the fence. Spacing between vertical members shall not exceed 1 3/4 inches (44 mm) in width. Where there are decorative cutouts within vertical members, spacing within the cutouts shall not exceed 1 3/4 inches (44 mm) in width.
5. Where the barrier is composed of horizontal and vertical members and the distance between the tops of the horizontal members is 45 inches (1143 mm) or more, spacing between vertical members shall not exceed 4 inches (102 mm). Where there are decorative cutouts within vertical members, spacing within the cutouts shall not exceed 1 3/4 inches (44 mm) in width.
6. Maximum mesh size for chain link fences shall be a 2 1/4-inch (57 mm) square unless the fence has slats fastened at the top or the bottom which reduce the openings to not more than 1 3/4 inches (44 mm).
7. Where the barrier is composed of diagonal members, such as a lattice fence, the maximum opening formed by the diagonal members shall not be more than 1 3/4 inches (44 mm).
8. Access gates shall comply with the requirements, Items 1 through 7, and shall be equipped to accommodate a locking device. Pedestrian access gates shall open outward away from the pool and shall be self-closing and have a self-latching device. Gates other than pedestrian access gates shall have a self-latching device.

